

# How to Find a Network Dentist

There are two easy ways to use our Find a Dentist (FAD) tool to locate a dentist in your area—by using your computer or using your smartphone.

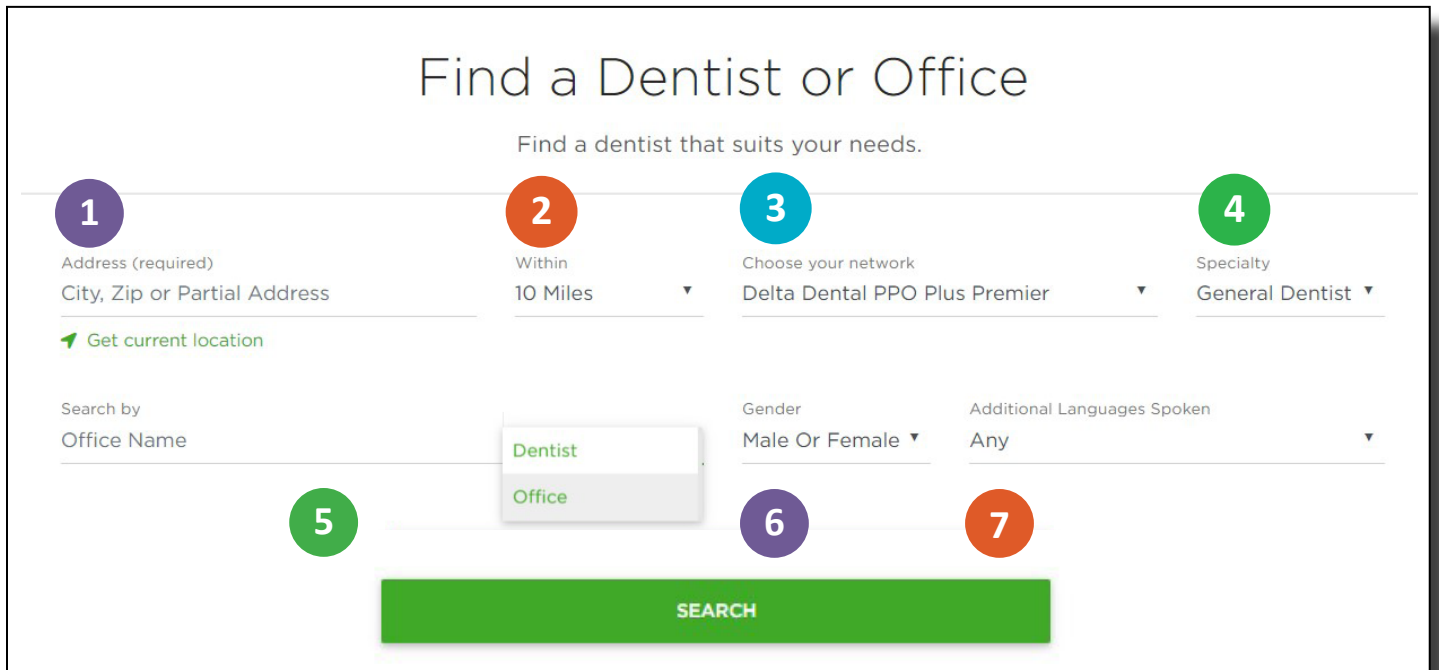

The screenshot shows the 'Find a Dentist or Office' tool interface. At the top, it says 'Find a dentist that suits your needs.' Below this, there are four numbered steps: 1. Address (required) City, Zip or Partial Address; 2. Within 10 Miles; 3. Choose your network Delta Dental PPO Plus Premier; 4. Specialty General Dentist. Below these are additional search options: Search by Office Name, Gender Male Or Female, and Additional Languages Spoken Any. A dropdown menu is open under 'Search by Office Name' showing 'Dentist' and 'Office' options. At the bottom, there is a large green 'SEARCH' button.

Access [DeltaDentalNJ.com/FAD](https://www.DeltaDentalNJ.com/FAD) from your computer in four easy steps:

- 1 **Enter** your city, zip code, or partial address
- 2 **Select** the distance you are willing to travel
- 3 **Select** a network
- 4 **Select** a specialty

You can also use our advanced search options to fine-tune your experience:

- 5 **Search** by office or dentist name
- 6 **Select** gender of practitioner
- 7 **Choose** additional languages spoken

## Access the Delta Dental mobile app from your smartphone in five easy steps:

- 1 Sign in, then click on “Find a Dentist” at the bottom of your home screen
- 2 Choose your plan type
- 3 Choose your dentist type
- 4 Add a dentist’s last name (optional)
- 5 Click “Search for dentist”

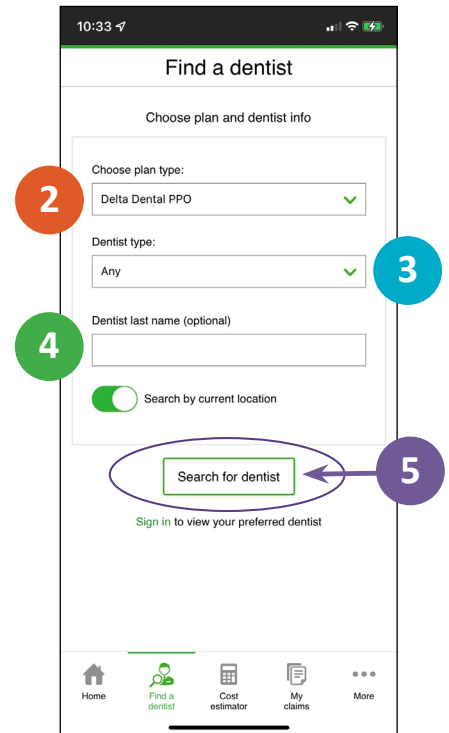
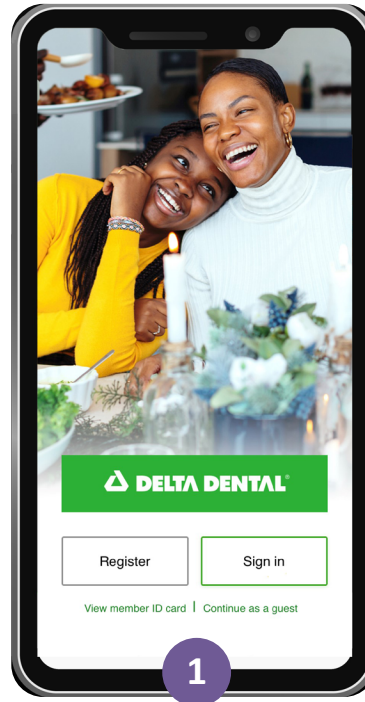

## Questions about the networks or a dentist’s participation?



Call the Delta Dental Customer Service Department at **800-452-9310**.